

# NH Fuse Bases for NH Style Photovoltaic Fuse Links

1500Vdc, Size 1



**Description:** Size 1 NH Fuse bases specifically designed for use with the Cooper Bussmann range of NH PV (Photovoltaic) fuse links.

**Packaging:** MOQ: 3  
Packaging 100% recyclable

**Technical Data:**  
Rated Voltage: 1500Vdc  
Rated Current: 250A  
Power Acceptance: 32W

**Catalogue Symbol:** SD1-D-PV

**Compatible Cooper Bussmann PV Fuse Range**  
PV-(amps)ANH1(see data sheet 720133)

**Accessories**  
Microswitches: 170H0236 or 170H0238, BVL50  
IP20 Finger-Safe Protection kit: TD1-IP20

**Standards/Approvals:** IEC 60269-1

## Dimensions (mm) 1-Pole, Size 1

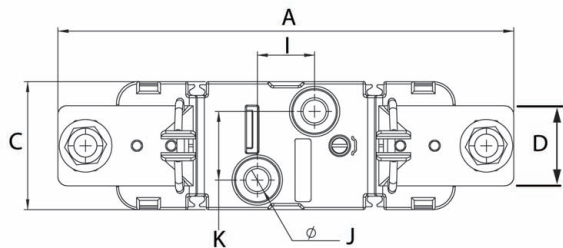
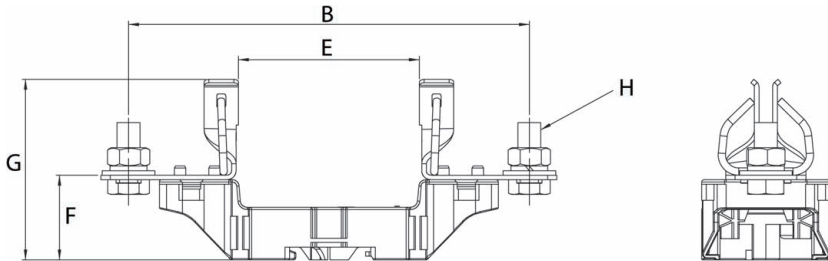

Size	Poles/Type	A	B	C	D	E	F	G	H	I	J	K
NH1	1-pole	199	175	56	35	79	37	78	M10x25	25	10	30